

TECO

OUTLINE DIMENSIONS 3-PHASE INDUCTION MOTOR

FRAME NO :

D160L

POLES	KW	HP	SYNCH RPM
2	18.5	25	3000
4	15	20	1500
6	11	15	1000
8	7.5	10	750

Totally Enclosed Fan-Cooled Type, Squirrel-Cage Rotor.

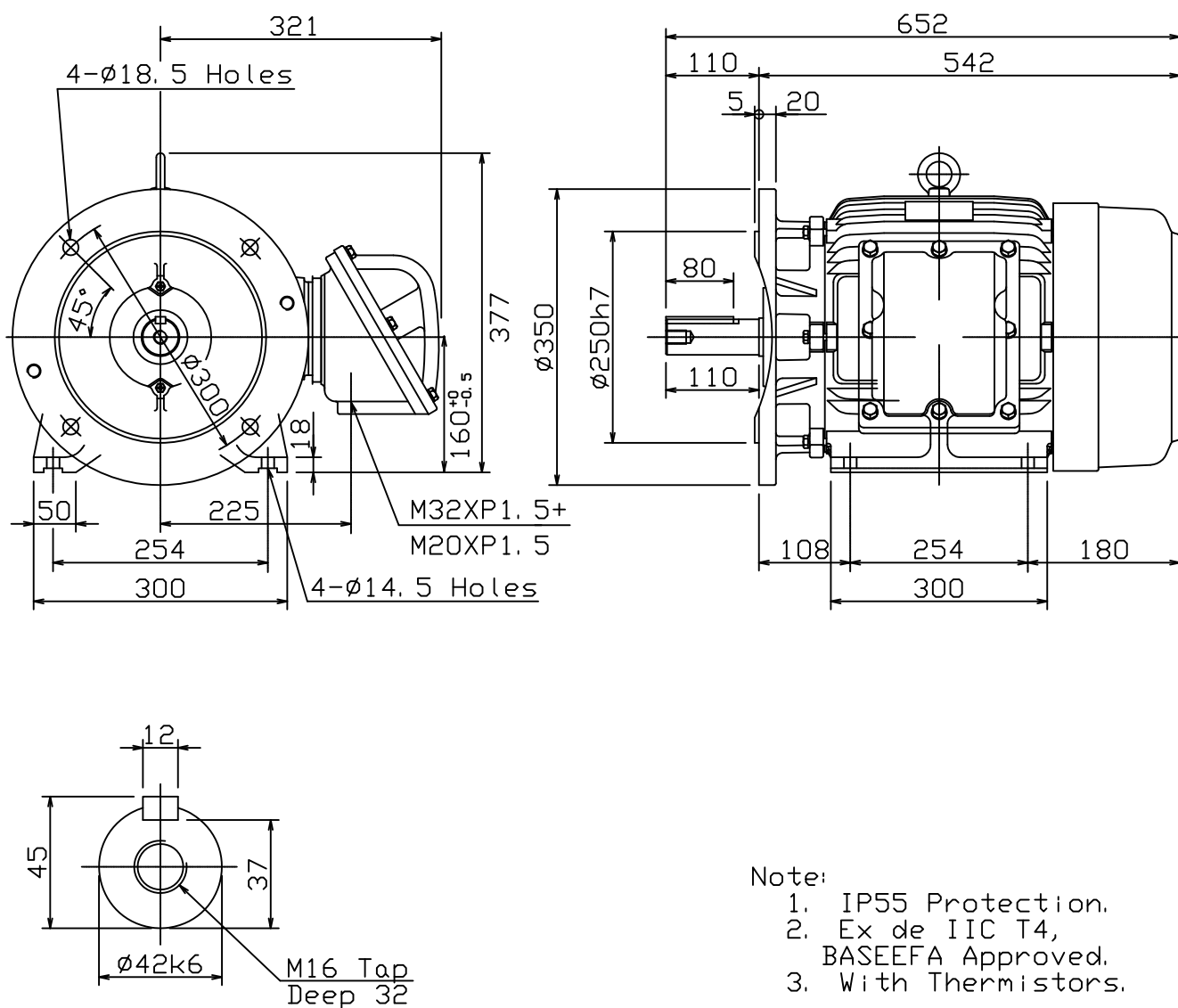

Note:

1. IP55 Protection.
2. Ex de IIC T4, BASEEFA Approved.
3. With Thermistors.

FOR TECO FLAMEPROOF MOTOR

DWN.	AY	01. 05. 19	<p>東元電機股份有限公司 TECO ELEC. & MACH. CO., LTD. TAIWAN R. O. C.</p>	<p>TYPE: AEHBXZ</p>
CHKD.	EJ	01. 05. 19		
APPD.	LM	01. 05. 19		